

## PLATFORMS

1. Insert tube in side clamp of the trestle leg and tighten the L-Bolt.
2. Insert other end of the tube in side clamp of the second trestle leg and tighten the L-Bolt.
3. Repeat steps 1 & 2 for top tube.
4. Repeat steps 1, 2 & 3 for second pair of trestle legs. Adjust to the required height. Insert the height adjustment pins and tighten the thumb screws. If the wheel kit is not being fitted, set the trestle legs apart and hook on the Loboard.

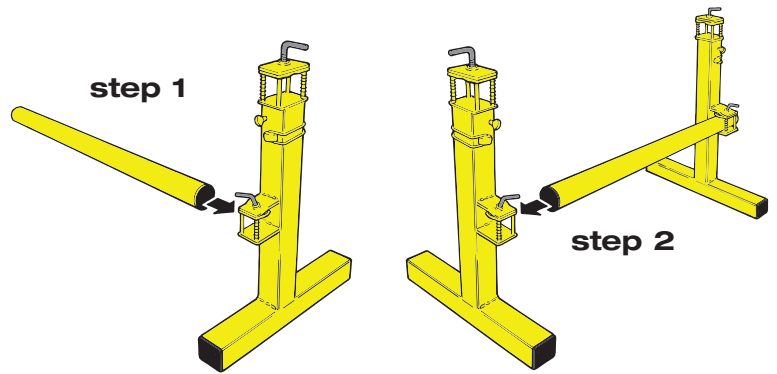

step 3

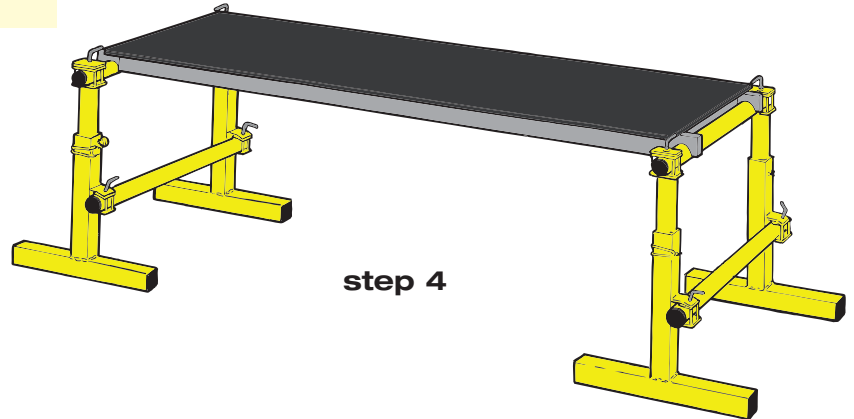
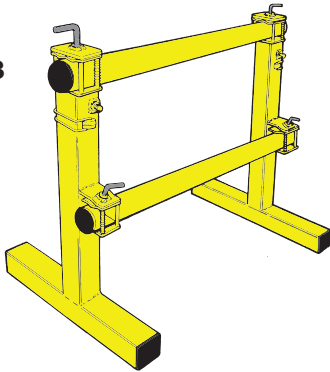

step 4

## WHEEL KIT

5. Slide wheel assembly unit onto foot of the trestle leg until the wheel pivot is directly beneath the upright. Repeat for the opposite trestle leg foot.
6. Slide bracing tube into clamps until the end just protrudes.
7. Tighten L-Bolts only sufficiently to hold the bracing tube in place.
8. Repeat steps 5, 6 & 7 for adjacent trestle legs.
9. Hook on Loboard and adjust clamps as necessary, and then fully tighten all 4 clamps

**Warning:** Always lock wheels before using or when parking.

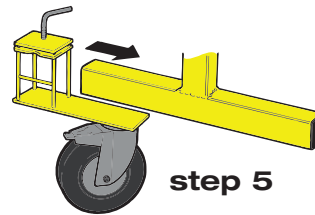

step 5

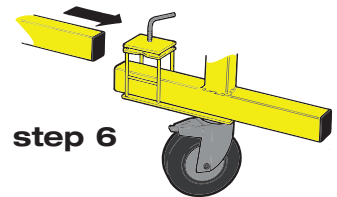

step 6

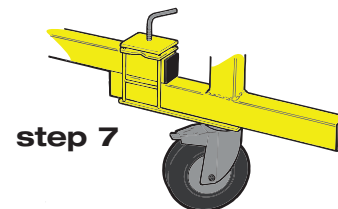

step 7

step 8

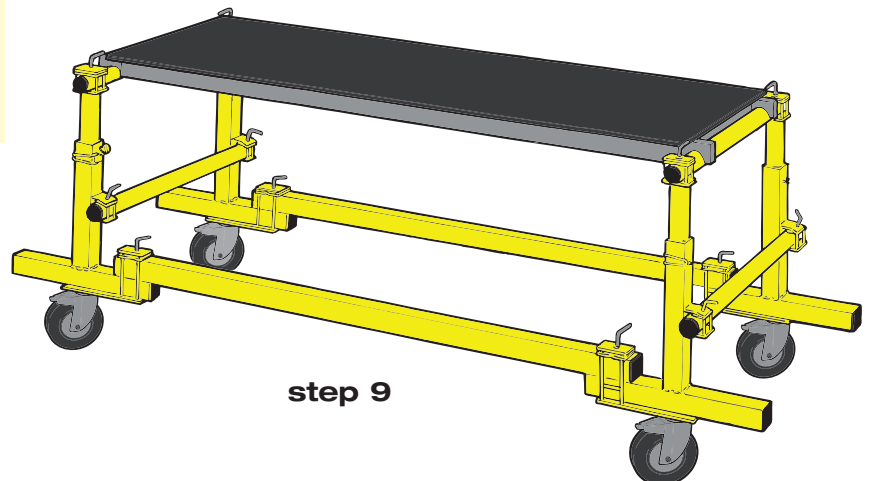
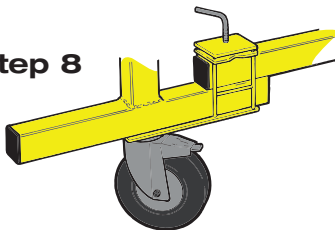

step 9

**SAFE WORKING LOAD**  
550lbs / 250kgs

**HAND TIGHT MEANS**  
5 Nm / 45 Inch-lbs